

# TRUE UNION BALL VALVE

# 雙由任球閥

# PVC & CPVC 1/2" ~ 2-1/2"\*

## DATA

- Working pressure : 150 PSI / 73° F
- Full port design
- Easy Maintenance
- Easy automated
- Teflon seat and Double O-ring stem seals
- Brand : SUPERTUNG

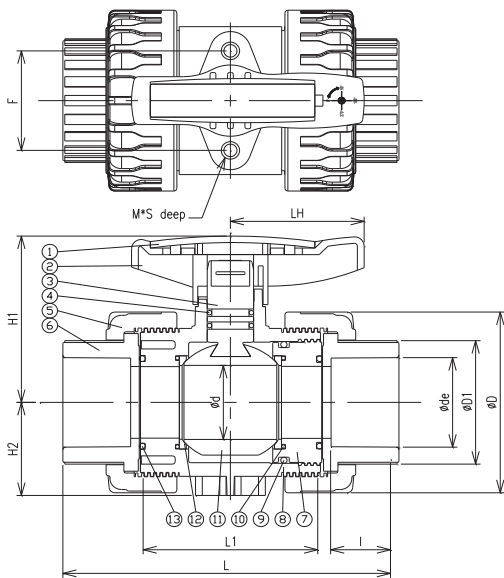

No	PARTS NAME	Q'TY	MATERIAL
1	HANDLE CAP	1	ABS
2	HANDLE	1	ABS
3	STEM	1	PVC,CPVC
4	O-RING	2	EPDM,FPM
5	NUT	2	PVC,CPVC
6	CONNECTOR	2	PVC,CPVC
7	CARRY	1	PVC,CPVC
8	BODY	1	PVC,CPVC
9	O-RING	1	EPDM,FPM
10	O-RING	2	EPDM,FPM
11	BALL	1	PVC,CPVC
12	SEAT	2	PTFE
13	O-RING	2	EPDM,FPM

SIZE	F	M	S
1/2" (15mm)	30	5	6
3/4" (20mm)	33	5	8
1" (25mm)	40	6	12
1-1/4" (32mm)	47	8	11
1-1/2" (40mm)	54	8	12
2" (50mm)	70	8	15
2-1/2" (65mm)*	70	8	15

SIZE	D	L	ANSI		DIN		JIS		CNS		NPT	BSPT	BSPF	D1	d	L1	LH	H1	H2
			¢de	I	¢de	I	¢de	I	¢de	I									
1/2" (15mm)	46	116	21.34	22.5	20	20	22	22.5	22	22.5	14	14	14	32	13	62	45	49	23.5
3/4" (20mm)	56	133	26.67	25.7	25	23	26	25.7	26	25.7	14	14	14	38	19	72	52	60	29
1" (25mm)	66	150	33.4	28.9	32	26	32	28.9	34	28.9	11.5	11	11	45	25	80	58	69	35
1-1/4" (32mm)	82	168	42.16	33.8	40	31	38	33.8	42	33.8	11.5	11	11	55	31	87	66	76	42.5
1-1/2" (40mm)	98	173	48.26	35	50	34	48	35	48	35	11.5	11	11	67	40	94	69	91	50.5
2" (50mm)	120	206	60.32	38.5	63	38.5	60	38.5	60	38.5	11.5	11	11	81	50	112	81	110	61
2-1/2" (65mm)*	120	211	73.02	41.5	75	41.5	76	41.5	76	41.5	8	11	11	89	50	112	81	110	61

\* Decrement type : inside diameter 50mm (減量型)

Technical Information

Item	Description	Size	Material		
			Body	Seat	O-ring
(1)	True Union Ball Valve	1/2"(DN15)	PVC,CPVC	PTFE	EPDM,FPM
(2)	True Union Ball Valve	3/4"(DN20)	PVC,CPVC	PTFE	EPDM,FPM
(3)	True Union Ball Valve	1"(DN25)	PVC,CPVC	PTFE	EPDM,FPM
(4)	True Union Ball Valve	1-1/4"(DN32)	PVC,CPVC	PTFE	EPDM,FPM
(5)	True Union Ball Valve	1-1/2"(DN40)	PVC,CPVC	PTFE	EPDM,FPM
(6)	True Union Ball Valve	2"(DN50)	PVC,CPVC	PTFE	EPDM,FPM
(7)	True Union Ball Valve	2-1/2"(DN65)*	PVC,CPVC	PTFE	EPDM,FPM

\* Decrement type : inside diameter 50mm (減量型)

Size	Hydrostatic Testing		Seat and O-ring Tests		Torque kgf*cm maximum	Cv
	Burst pressure water(kgf/cm <sup>2</sup> ) minimum	Long-term behaviour test water(kgf/cm <sup>2</sup> )	Seat valve close air (kgf/cm <sup>2</sup> )	O-ring valve open air (kgf/cm <sup>2</sup> )		
1/2"(DN15)	42	22	6	6	25	8
3/4"(DN20)	42	22	6	6	30	15
1"(DN25)	42	22	6	6	35	29
1-1/4"(DN32)	42	22	6	6	65	75
1-1/2"(DN40)	42	22	6	6	75	90
2"(DN50)	42	22	6	6	95	140
2-1/2"(DN65)*	42	22	6	6	95	140

\* Decrement type : inside diameter 50mm (減量型)

Working pressure vs. Temperature

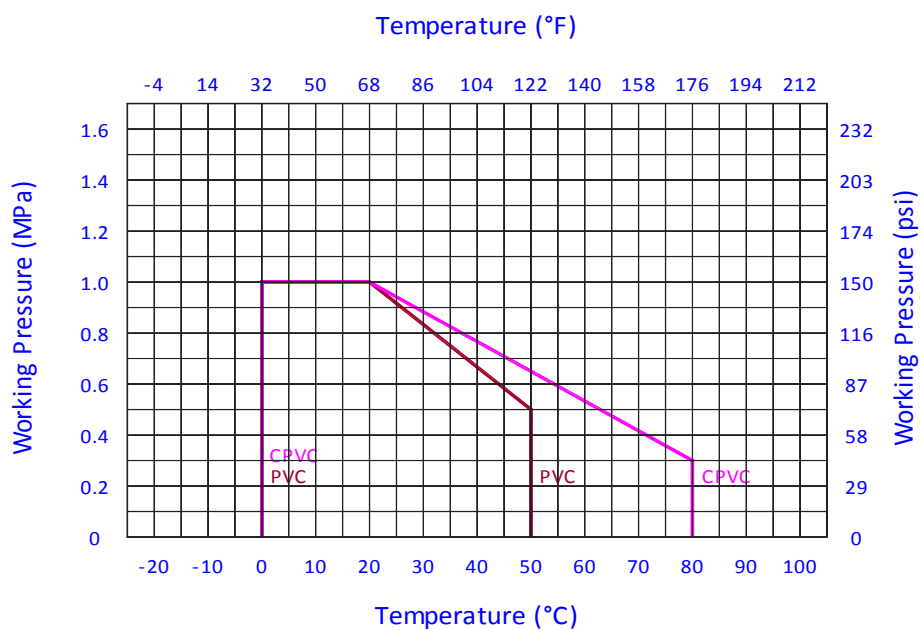

# TRUE UNION BALL VALVE

# 雙由任球閥 PVC & CPVC 2-1/2" ~ 4"

## DATA

- Working pressure : 150 PSI / 73° F
- Full port design
- Easy Maintenance
- Easy automated
- Teflon seat and Double O-ring stem seals
- Brand : SUPERTUNG

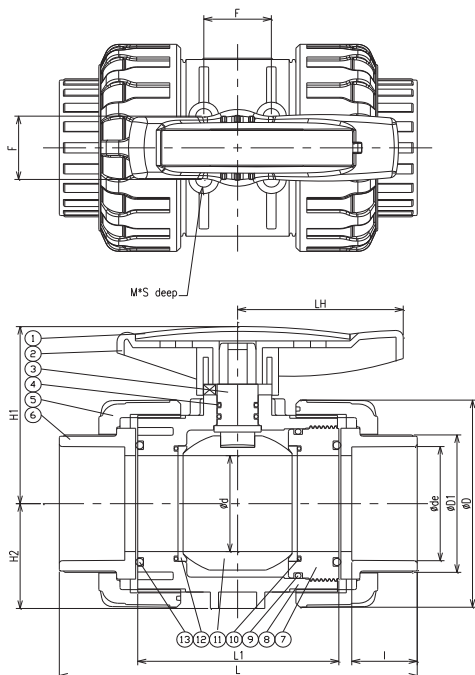

SIZE	F	M	S
2-1/2" (65mm)	49.5	8	15
3" (80mm)	49.5	8	15
4" (100mm)	72	10	20

No	PARTS NAME	Q'TY	MATERIAL	No	PARTS NAME	Q'TY	MATERIAL
1	HANDLE CAP	1	ABS	8	BODY	1	PVC,CPVC
2	HANDLE	1	ABS	9	O-RING	1	EPDM,FPM
3	STEM	1	PVC,CPVC	10	O-RING	2	EPDM,FPM
4	O-RING	2	EPDM,FPM	11	BALL	1	PVC,CPVC
5	NUT	2	PVC,CPVC	12	SEAT	2	PTFE
6	CONNECTOR	2	PVC,CPVC	13	O-RING	2	EPDM,FPM
7	CARRY	1	PVC,CPVC				

SIZE	D	L	ANSI		DIN		JIS		CNS		NPT	BSPT	BSPF	D1	d	L1	LH	H1	H2
			Øde	I	Øde	I	Øde	I	Øde	I									
2-1/2" (65mm)	162	254	73.02	45	75	45	76	45	76	45	8	11	11	92	75	147	118	140	82
3" (80mm)	162	262	88.9	48	90	51	89	51	89	51	8	11	11	108	75	147	118	140	82
4" (100mm)	220	311	114.3	57.5	110	61	114	61	114	61	8	11	11	134	100	177	140	185	111

Technical Information

Item	Description	Size	Material		
			Body	Seat	O-ring
(1)	True Union Ball Valve	2-1/2"(DN65)	PVC,CPVC	PTFE	EPDM,FPM
(2)	True Union Ball Valve	3"(DN80)	PVC,CPVC	PTFE	EPDM,FPM
(3)	True Union Ball Valve	4"(DN100)	PVC,CPVC	PTFE	EPDM,FPM

Size	Hydrostatic Testing		Seat and O-ring Tests		Torque kgf*cm	Cv
	Burst pressure water (kgf/cm <sup>2</sup> ) minimum	Long-term behaviour test water (kgf/cm <sup>2</sup> )	Seat valve close air (kgf/cm <sup>2</sup> )	O-ring valve open air (kgf/cm <sup>2</sup> )		
2-1/2"(DN65)	31	22	6	6	150	330
3"(DN80)	31	22	6	6	150	480
4"(DN100)	31	22	6	6	250	600

Working pressure vs. Temperature

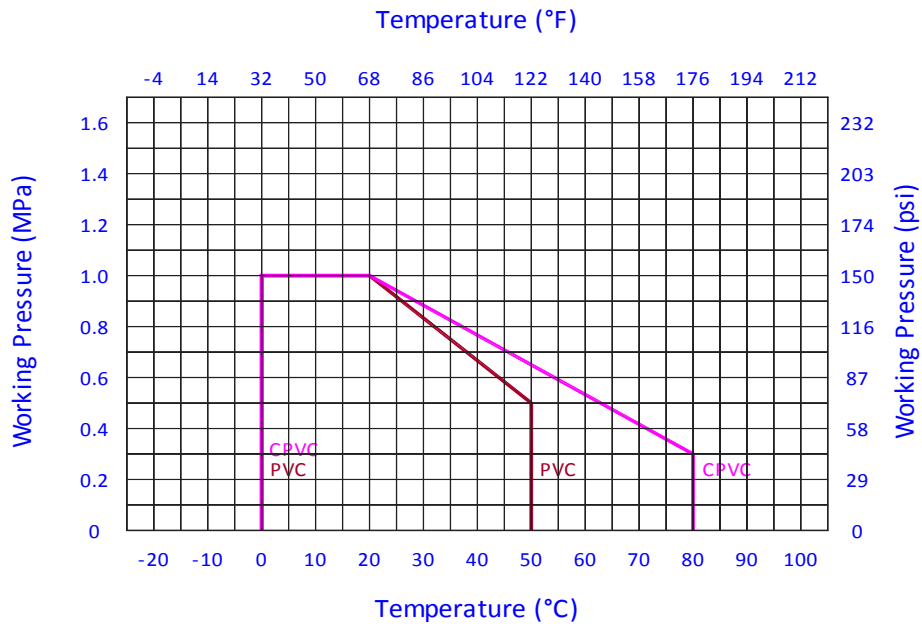

# TRUE UNION BALL VALVE

## 雙由任球閥 PPH 1/2" ~ 2"



### DATA

- Working pressure : 10 bar / 20°C
- Full port design
- Easy Maintenance
- Easy automated
- Teflon seat and Double O-ring stem seals
- Brand : SUPERTUNG

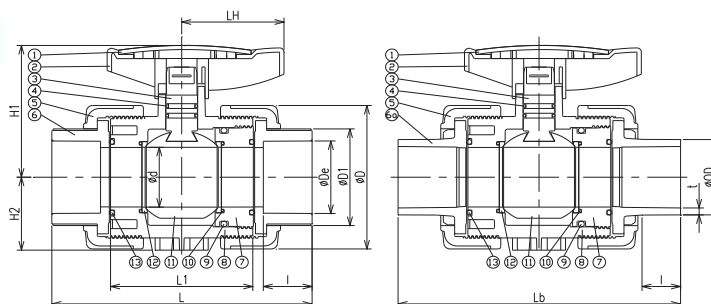

No	PARTS NAME	Q'TY	MATERIAL
1	HANDLE CAP	1	ABS
2	HANDLE	1	ABS
3	STEM	1	PPH
4	O-RING	2	EPDM,FPM
5	NUT	2	PPH
6a	BUTT	2	PPH
6	CONNECTOR	2	PPH
7	CARRY	1	PPH
8	BODY	1	PPH
9	O-RING	1	EPDM,FPM
10	O-RING	2	EPDM,FPM
11	BALL	1	PPH
12	SEAT	2	PTFE
13	O-RING	2	EPDM,FPM

SIZE	D	L	DIN Fusion		DIN BUTT			CNS Fusion	
			Øde	I	ØOD	t	I	Øde	I
1/2" (15mm)	45	114	20	16	20	1.9	25	22	22
3/4" (20mm)	55	132	25	18	25	2.3	25	27*	25
1" (25mm)	66	148	32	20	32	2.9	25	34	29
1-1/4" (32mm)	81	167	40	22	40	3.7	25	42	32
1-1/2" (40mm)	97	171	50	25	50	4.7	25	48	35
2" (50mm)	119	203	63	29	63	5.8	30	60	38

SIZE	NPT	BSPT	BSPF	D1	d	LH	L1	H1	H2	Lb
1/2" (15mm)	14	14	14	31	13	45	60	48	23.5	138.5
3/4" (20mm)	14	14	14	37	19	52	72	59	29	153.5
1" (25mm)	11.5	11	11	44	25	58	78	68	35	167
1-1/4" (32mm)	11.5	11	11	54	30	66	87	78	42.5	176
1-1/2" (40mm)	11.5	11	11	66	40	69	92	89	50.5	191
2" (50mm)	11.5	11	11	79	50	81	112	108	61	222

Technical Information

Item	Description	Size	Material		
			Body	Seat	O-ring
(1)	True Union Ball Valve	1/2"(DN15)	PPH	PTFE	EPDM,FPM
(2)	True Union Ball Valve	3/4"(DN20)	PPH	PTFE	EPDM,FPM
(3)	True Union Ball Valve	1"(DN25)	PPH	PTFE	EPDM,FPM
(4)	True Union Ball Valve	1-1/4"(DN32)	PPH	PTFE	EPDM,FPM
(5)	True Union Ball Valve	1-1/2"(DN40)	PPH	PTFE	EPDM,FPM
(6)	True Union Ball Valve	2"(DN50)	PPH	PTFE	EPDM,FPM

Size	Hydrostatic Testing		Seat and O-ring Tests		Torque kgf*cm maximum	Cv
	Burst pressure water(kgf/cm <sup>2</sup> ) minimum	Long-term behaviour test water (kgf/cm <sup>2</sup> )	Seat valve close air (kgf/cm <sup>2</sup> )	O-ring valve open air (kgf/cm <sup>2</sup> )		
1/2"(DN15)	31	22	6	6	25	8
3/4"(DN20)	31	22	6	6	30	15
1"(DN25)	31	22	6	6	35	29
1-1/4"(DN32)	31	22	6	6	65	75
1-1/2"(DN40)	31	22	6	6	75	90
2"(DN50)	31	22	6	6	95	140

Working pressure vs. Temperature

